



AUTOMATIC SENSOR OPERATED TAPS



Up to 70% Water Savings

To operate simply put your hands in front of the sensor. Remove your hands and the tap will automatically turn itself off again after a few seconds. Optional Automatic "Purge" Facility available for taps not used for long periods.

**Hygienic "Touch-Free" Sensor Operation • Mains or Battery Powered Kits Available
Water & Energy Conservation • Ideal for Disabled Facilities • Infection Control**



CPTSN Short-neck model (Chrome Finish)



CPTHN High-neck model (Chrome Finish)



SS32 basin or worktop model (Stainless Steel)



SS45 basin or worktop model (Stainless Steel)



SSHN High-neck model (Stainless Steel)



SSSN Short-neck model (Stainless Steel)



CMT basin or worktop model (Chrome Finish)



SSTW wall/panel mounted model (Stainless Steel)

Earn BREEAM W1 credits

Sensor taps are supplied with 5 Lpm flow regulators (or optional sprayheads for low water pressure applications)



New. Optional hand held remote adjuster to allow you to alter:

- water run-on time per operation
- sensitivity
- optional automatic purge facility (to help reduce dead-legs)
- optional 2 minute valve open chlorination facility

For all sensor tap kits:

Each tap kit c/w: WRAS approved 15mm solenoid valve and tap with integral sensor. Battery powered models come with a separate battery pack and require no electricity supply at all. Mains powered kits come with a separate low voltage 6V dc PSU/Transformer Unit.

Water pressure: The standard solenoid valve is rated for water pressures of 0.75 Bar – 10 Bar, although we suggest a maximum pressure of 5 Bar. We also offer optional low pressure valves. Please contact us to discuss this option.

Electrical requirements: Each kit requires a 3 amp protected fused spur. If specified at time of order we can arrange the kits so you can run up to 3 taps from a single 6v Power Supply Unit.

Stainless steel taps: Standard finish is "brushed" stainless steel. Optional "polished" stainless steel finish also available.

NB Please make sure there are no lights shining (or being reflected) directly into the sensor as this can make the tap false trigger.



Taps come supplied with PEX lined WRAS approved flexi-hose pipes. Optional copper tails available on request.

Basin or Worktop Mounted Taps

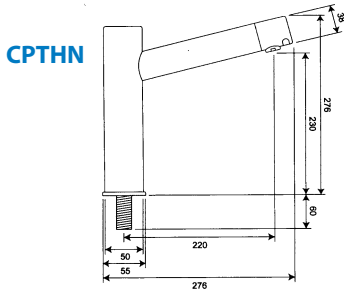

Order Code Description
 CPTHN-B Battery powered chrome sensor tap kit. 38mm diameter spout.
 CPTHN-M Mains powered version. Fixing 3/4" BSP. (28mm Ø clearance drill hole)

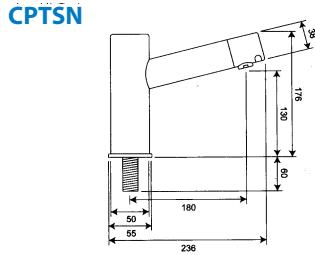

Order Code Description
 CPTSN-B Battery powered chrome sensor tap kit. 38mm diameter spout.
 CPTSN-M Mains powered version. Fixing 3/4" BSP. (28mm Ø clearance drill hole)

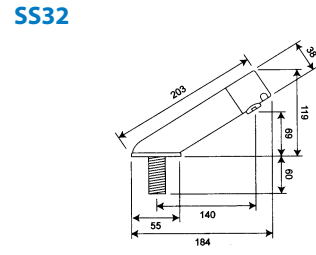

Order Code Description
 SS32-B Battery powered stainless steel sensor tap kit. 38mm diameter spout.
 SS32-M Mains powered version. Tap is at 32° angle from worktop. Fixing 3/4" BSP. (28mm Ø clearance drill hole)

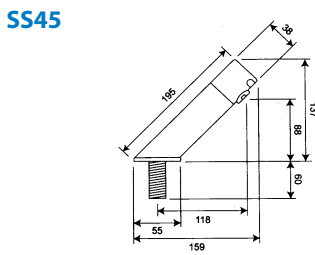

Order Code Description
 SS45-B Battery powered stainless steel sensor tap kit. 38mm diameter spout.
 SS45-M Mains powered version. Tap is at 45° angle from worktop. Fixing 3/4" BSP. (28mm Ø clearance drill hole)

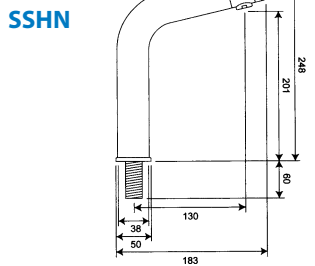

Order Code Description
 SSHN-B Battery powered stainless steel sensor tap kit. 38mm diameter spout.
 SSHN-M Mains powered version. Fixing 3/4" BSP. (28mm Ø clearance drill hole)

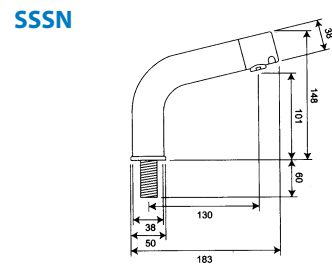

Order Code Description
 SSSN-B Battery powered stainless steel sensor tap kit. 38mm diameter spout.
 SSSN-M Mains powered version. Fixing 3/4" BSP. (28mm Ø clearance drill hole)

Wall/Panel Mounted Tap

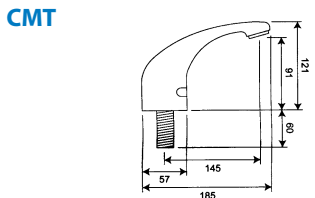

Order Code Description
 CMT-B Battery powered chrome sensor tap kit. 38mm diameter spout.
 CMT-M Mains powered version. Fixing 3/4" BSP. (28mm Ø clearance drill hole)

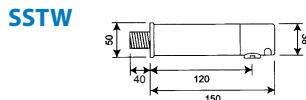

Order Code Description
 SSTW-B Battery powered stainless steel sensor tap kit. 38mm diameter spout.
 SSTW-M Mains powered version. Standard projection length 150mm (200mm & 250mm models available on request). Sensor is at spout end. Tap should be fitted on wall minimum 300mm above bottom of basin (450mm minimum if basin is metallic). Fixing 3/4" BSP. (28mm Ø clearance drill hole).

AVAILABLE FOR HOSPITALS
 SSTW (Scrub) model for surgeon scrub up sinks with 20 second water run-on time. Please call us to discuss this option.

Example of installation

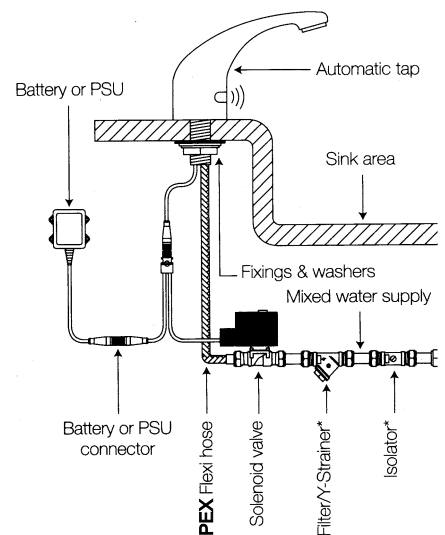

ROBERT PEARSON & COMPANY LTD

Post Office House, Post Office Lane
 Stockton, Warminster
 Wiltshire BA12 0SE

Telephone: (01985) 850954
 Facsimile: (01985) 850112
 E-Mail: sales@robertpearson.co.uk
 Website: www.robertpearson.co.uk