

Anti-Ligature and/or Vandal Resistant Tap Spouts and Shower Heads

Ideal for Custodial/Mental Health applications as well as Public/Commercial applications where vandalism might be a risk.

Use our remote anti-ligature no-touch sensor kits or touchpad switch kits, to control the water flow to these spouts. Please contact us for more information.

Anti-Ligature and/or Vandal Resistant Tap Spouts

ALN-DM(v2) Basin/Deck Mounted Anti-Ligature Stainless Steel Tap Spout

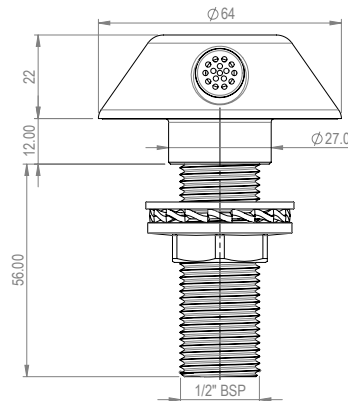

Basin/Deck Mounted
Order Code:
 ALN-DM(v2) Spout

VRTS-PM Panel Mounted Vandal Resistant Stainless Steel Tap Spout

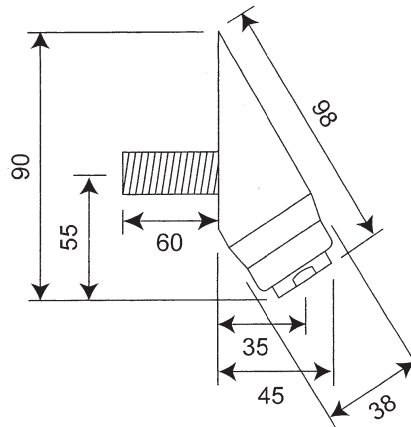

We offer optional extension threads if fitting spout through a brick wall. Please advise of total wall thickness when enquiring.

Panel Mounted
Order Code:
 VRTS-PM Tap Spout

VRBS(Tap)-PM Panel Mounted Vandal Resistant Stainless Steel Tap Spout

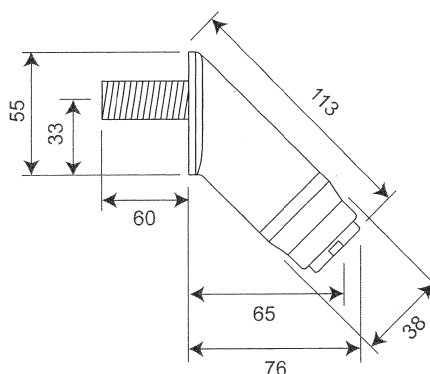

We offer optional extension threads if fitting spout through a brick wall. Please advise of total wall thickness when enquiring.

Panel Mounted
Order Codes:
 VRBS(Tap)-PM Tap Spout

Anti-Ligature and/or Vandal Resistant Shower Heads

Ideal for Custodial/Mental Health applications as well as Public/Commercial applications where vandalism might be a risk.

Use our remote anti-ligature no-touch sensor kits or touchpad switch kits, to control the water flow to these spouts. Please contact us for more information.

ALCMSH-PM Ceiling Mounted Anti-Ligature Shower Head

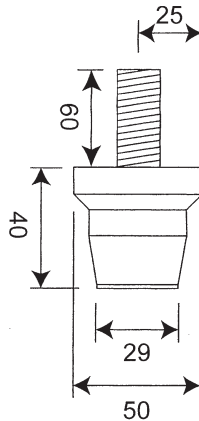

Ceiling Mounted

Order Code:

ALCMSH-PM Shower Head

ALCFM-SH Ceiling Flush Mounted Anti-Ligature Shower Head

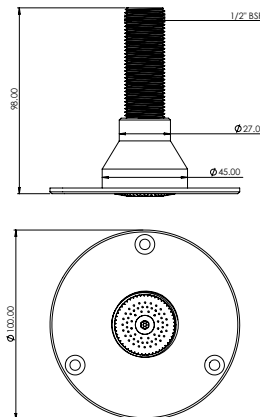
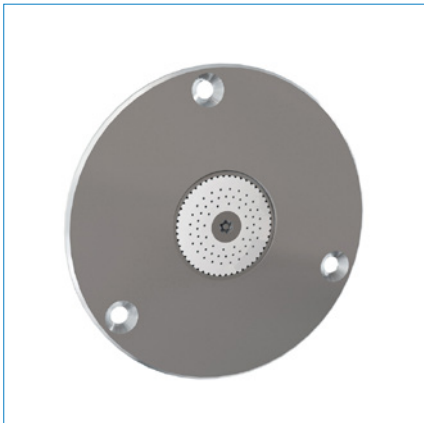

Ceiling Mounted

Order Code:

ALCFM-SH Shower Head

VRSH-PM Panel Mounted Vandal Resistant Stainless Steel Shower Head

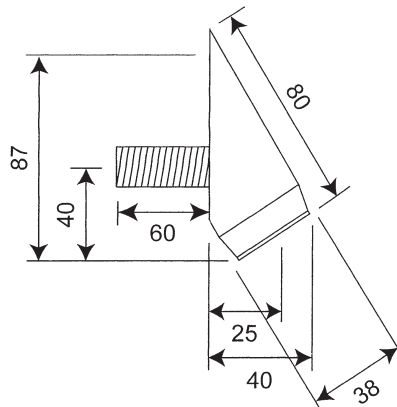

Panel Mounted

Order Code:

VRSH-PM Shower Head

We offer optional extension threads if fitting shower head through a brick wall. Please advise of total wall thickness when enquiring.

Temperature Blending Valve (Manually Adjustable)

In public areas using a TMV2/3 Thermostatic Mixing Valve (set at 40°C *approx.*) is considered suitable to provide safe pre-mixed warm water to an appliance (tap, shower etc). The temperature is not adjustable by the public, only by the building manager.

If however you want to offer your customer the ability to manually adjust the temperature of the water between say 40°C and cold, then this robust & tamper proof Temperature Blending Valve should be used (NB: We would strongly recommend that you also use a Thermostatic Mixing Valve to safely control the maximum water temperature into the Temperature Blending Valve). We can also supply TMV3 Mixing Valves.

Typical Installation: Plumbing guidelines for Shower using Temperature Blending Valve

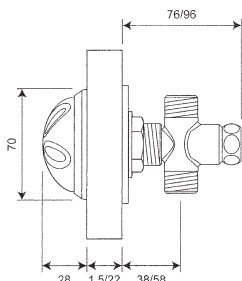
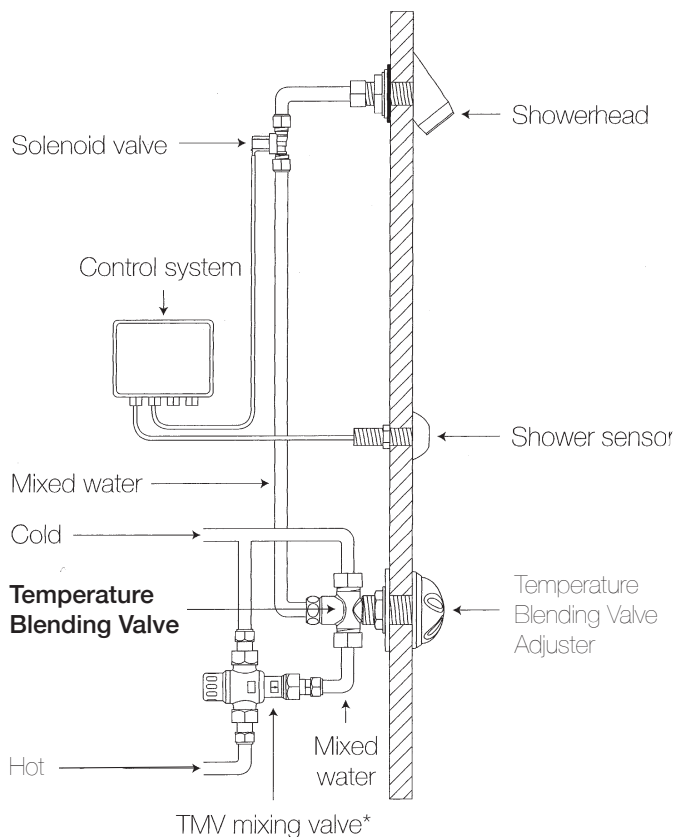

Order Code
TBV/ADJ/22

Application
For 1.5mm – 22mm wall thickness.
Fixing ¾" BSP. (Ø28mm drill hole)

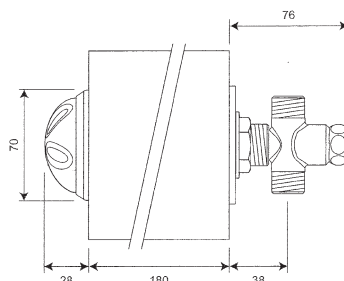

Order Code
TBV/ADJ/180

Application
For up to 180mm wall thickness.
Fixing ¾" BSP. (Ø28mm drill hole)

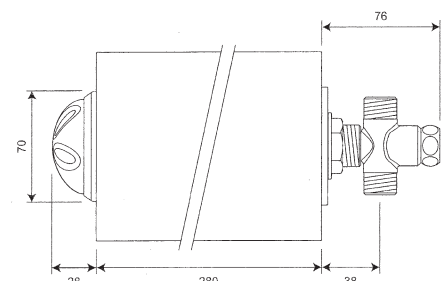

Order Code
TBV/ADJ/280

Application
For up to 280mm wall thickness.
Fixing ¾" BSP. (Ø28mm drill hole)

Anti-Ligature and/or Vandal Resistant Bath Spouts

Ideal for Custodial/Mental Health applications as well as Public/Commercial applications where vandalism might be a risk.

Use our remote anti-ligature no-touch sensor kits or touchpad switch kits, to control the water flow to these spouts. Please contact us for more information.

ALN-BATH-DM Deck Mounted Anti-Ligature Stainless Steel Bath Spout

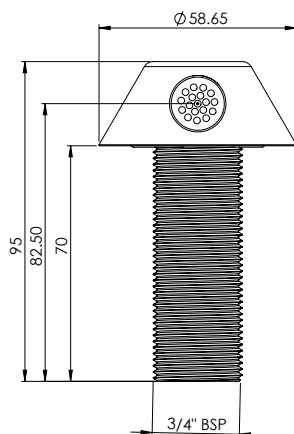

Order Code: ALN-BATH-DM Bath Spout

Cut-out hole Ø28mm drill hole required
Minimum flow pressure 1 Bar
Flow rate 18 LPM at 1 Bar (Unrestricted)

VRBS-PM Vandal Resistant Stainless Steel Bath Spout

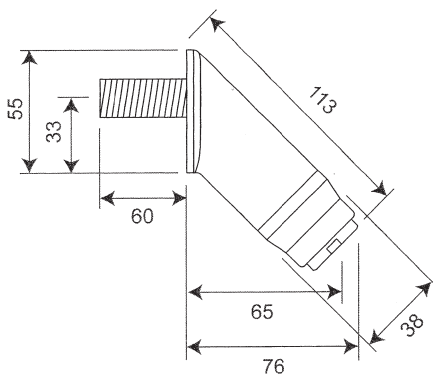

Panel Mounted
Order Codes:
VRBS-PM Bath Spout c/w
unrestricted nozzle

We offer optional extension threads if fitting spout through a brick wall. Please advise of total wall thickness when enquiring.



ROBERT PEARSON & COMPANY LTD

Post Office House, Post Office Lane
Stockton, Warminster
Wiltshire BA12 0SE

Telephone: (01985) 850954
Facsimile: (01985) 850112
E-Mail: sales@robertpearson.co.uk
Website: www.robertpearson.co.uk