

# Perlator® Honeycomb model combined aerator and flow regulator

NO PLUMBING REQUIRED | WATER & ENERGY SAVING | EVEN WATER DISTRIBUTION

Simply replace existing tap aerator or flow straightener

## Neoperl Perlator® Honeycomb Aerator | PCA® (Pressure Compensating) Model

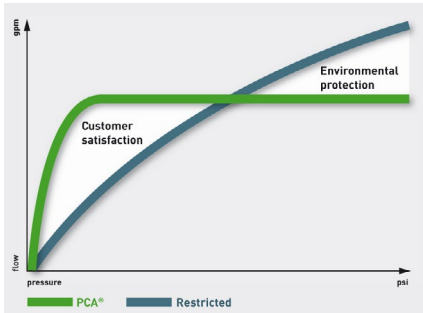

Water consumption: as much as necessary (customer satisfaction), but only as little as possible (environmental protection).

### PCA® versions provide a constant & maximum flow rate irrespective of pressure fluctuations

All Neoperl PCA® inserts are equipped with a flow regulator. The flow regulator is composed of a **colour-coded body** and a **dynamic o-ring**. The o-ring reacts to pressure change and alters its shape to adjust the amount of water flowing through the flexible gap.

### Operating water pressure 1 Bar to 6 Bar

Where flow rates are stated in gallons/min (**gpm max.**) this refers to a US gallon (3.8 litre/min approx.) and the flow rate will not exceed that stated providing the water pressure is correct. Where flow rates are stated in litres/min (**l/min**) this is subject to  $\pm 10\%$  deviation.

## RP/CAAFR Perlator-HC | Pressure Compensating Flow Regulator & Aerator



### NEOPERL® AERATORS

- control the stream straightness and diameter
- reduce splash by aerating the stream and eliminating side spray
- save water and reduce energy costs
- meet local plumbing codes and standards

### PERLATOR® HONEYCOMB FEATURES

- extended life
- perfect stream quality even under difficult flow conditions
- very low noise level
- damage proof: unlike conventional wire mesh screens, the HONEYCOMB structure cannot be crushed
- integrated anti-clogging dome screen filters sediments and particles

## Available Sizes and housings

### STANDARD (STD)

Female M22

Male M24

US Female 55/64"-27 UNS-2B

US Male 15/16"-27 UNS-2A

Dual Thread 15/16"-27/ 55/64"-27

Euro Male (with side flats) 15/16"-27

### TINY JUNIOR (TJ)

Female M19

Male M20

### TOM THUMB (TT)

Female M16

Male M18

IG (female) 3/8"

### JUNIOR (JR)

US Female 3/4"-27 UNS-2B

US Male 13/16"-27 UNS-2A

### Tamper-Proof Female M22 and Male M24 Housings Available

Rotating sleeve construction to make the aerator and housing theft-proof. Special key is required for removal.

### Compact Tamper Proof Male M24 housing

is compatible only with **TINY JUNIOR (TJ)**

Inserts

## Standard (STD) Size PCA® Model – Pressure Compensating Aerator

The pressure compensating flow regulator produces – by means of the o-ring – an almost constant flow rate regardless of pressure fluctuations

**STD Perlator® Honeycomb** for water pressure 1 bar – 6 bar

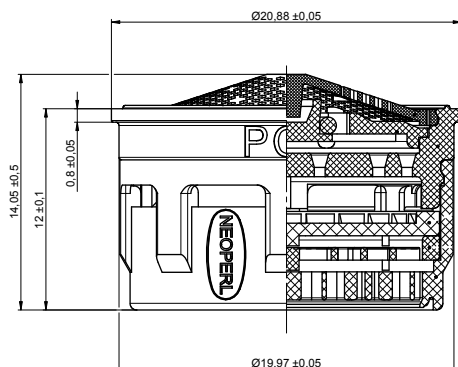

Standard (STD) Size PCA® Models			Order Codes		
Flow Rate (± 10%) Litres/min	Flow Rate US gallons/min	Colour Code	Standard (STD) Insert only	c/w Female M22 Housing & Washer	c/w Male M24 Housing & Washer
	1.0 gpm max.	Blue	RP/40.2058.000	RP/40.2058.023	RP/40.2058.033
	1.2 gpm max.	Pink	RP/40.2060.000	RP/40.2060.023	RP/40.2060.033
5.0 l/min		Orange	RP/40.2051.000	RP/40.2051.023	RP/40.2051.033
	1.5 gpm max.	Green	RP/40.2056.000	RP/40.2056.023	RP/40.2056.033
6.0 l/min		Black	RP/40.2052.000	RP/40.2052.023	RP/40.2052.033
	1.75 gpm max.	Light Blue	RP/40.2061.000	RP/40.2061.023	RP/40.2061.033
7.0 l/min		Light Green	RP/40.2055.000	RP/40.2055.023	RP/40.2055.033
	2.0 gpm max.	Lilac	RP/40.2057.000	RP/40.2057.023	RP/40.2057.033
	2.2 gpm max.	Yellow	RP/40.2053.000	RP/40.2053.023	RP/40.2053.033
8.0 l/min		White	RP/40.2054.000	RP/40.2054.023	RP/40.2054.033

**Female M22 and Male M24 Neoperl®** chrome housing dimensions for standard (STD) aerator.

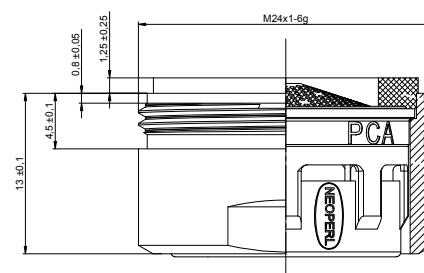
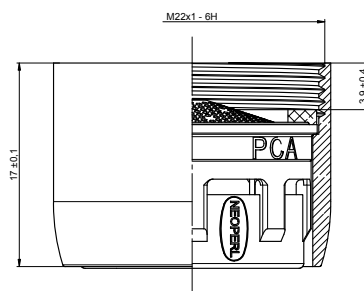

**Female M22 and Male M24 Neoperl®** tamper proof chrome housings for standard (STD) aerator

Tamper proof housings require a special key (RP/BX.011C.1) for fitting and removal



**Female M22 tamper proof housings.**

Part no.: 40.xxxx.513 (xxxx depending on insert)



**Male M24 tamper proof housings.**

Part no.: 40.xxxx.523 (xxxx depending on insert)

## Tiny Junior (TJ) Size PCA® Model – Pressure Compensating Aerator

The pressure compensating flow regulator produces – by means of the o-ring – an almost constant flow rate regardless of pressure fluctuations

**TJ Perlator® Honeycomb** for water pressure 1 bar – 6 bar

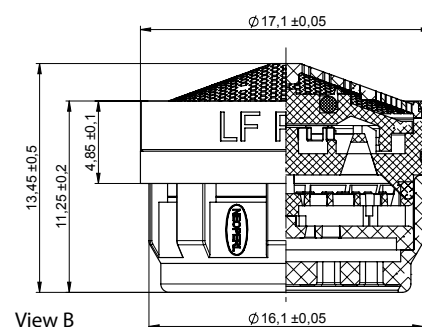
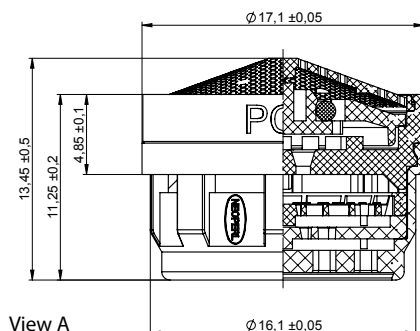

Tiny Junior (TJ) Size PCA® Models			Order Codes		
Flow Rate - View B Litres/min (± 10%)	Flow Rate - View B US gallons/min	Colour Code	Tiny Junior (TJ) Insert only	c/w Female M19 Housing & Washer	c/w Male M20 Housing & Washer
	0.5 gpm max.	Lime	RP/43.2059.000	RP/43.2059.023	RP/43.2059.033
	1.0 gpm max.	Blue	RP/43.2058.000	RP/43.2058.023	RP/43.2058.033
	1.2 gpm max.	Pink	RP/43.2060.000	RP/43.2060.023	RP/43.2060.033
Flow Rate (View A)		Colour Code	TJ Insert	c/w Female M19	c/w Male M20
5.0 l/min		Orange	RP/43.2051.000	RP/43.2051.023	RP/43.2051.033
	1.5 gpm max.	Green	RP/43.2056.000	RP/43.2056.023	RP/43.2056.033
	1.75 gpm max.	Light Blue	RP/43.2061.000	RP/43.2061.023	RP/43.2061.033
7.0 l/min		Light Green	RP/43.2055.000	RP/43.2055.023	RP/43.2055.033
	2.0 gpm max.	Lilac	RP/43.2057.000	RP/43.2057.023	RP/43.2057.033
	2.2 gpm max.	Yellow	RP/43.2053.000	RP/43.2053.023	RP/43.2053.033
8.0 l/min		White	RP/43.2054.000	RP/43.2054.023	RP/43.2054.033

**Female M19 and Male M20 Neoperl® chrome housing dimensions for Tiny Junior (TJ) aerator**

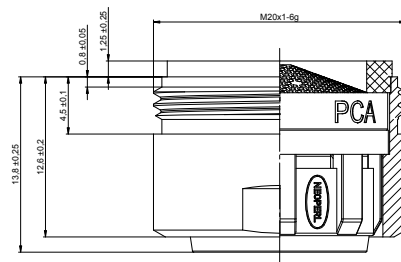
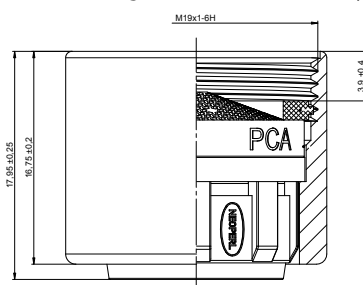

**Male M24 Neoperl® Compact tamper proof chrome housing for Tiny Junior (TJ) aerator**

Tamper proof housings require a special key (RP/BX.011C.1) for fitting and removal



# Tom Thumb (TT) Size PCA® Model – Pressure Compensating Aerator

The pressure compensating flow regulator produces – by means of the o-ring – an almost constant flow rate regardless of pressure fluctuations

## TT Perlator® Honeycomb for water pressure 1 bar – 6 bar

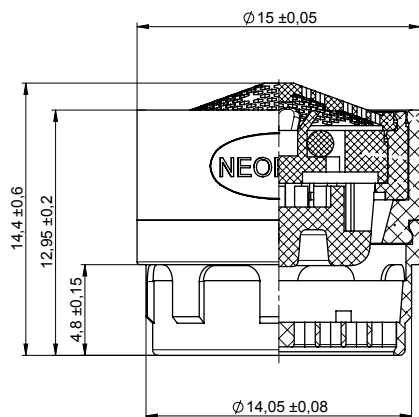

Tom Thumb (TT) Size PCA® Models			Order Codes		
Flow Rate Litres/min (± 10%)	Flow Rate US gallons/min	Colour Code	Tom Thumb (TT) Insert only	c/w Female M16 Housing & Washer	c/w Male M18 Housing & Washer
	1.0 gpm max.	Blue	RP/44.3058.000	RP/44.3058.023	RP/44.3058.033
	1.2 gpm max.	Pink	RP/44.3060.000	RP/44.3060.023	RP/44.3060.033
5.0 l/min		Orange	RP/44.3051.000	RP/44.3051.023	RP/44.3051.033
	1.5 gpm max.	Green	RP/44.3056.000	RP/44.3056.023	RP/44.3056.033
	1.75 gpm max.	Light Blue	RP/44.3061.000	RP/44.3061.023	RP/44.3061.033
7.0 l/min		Light Green	RP/44.3055.000	RP/44.3055.023	RP/44.3055.033
	2.0 gpm max.	Lilac	RP/44.3057.000	RP/44.3057.023	RP/44.3057.033
	2.2 gpm max.	Yellow	RP/44.3053.000	RP/44.3053.023	RP/44.3053.033
8.0 l/min		White	RP/44.3054.000	RP/44.3054.023	RP/44.3054.033

## Female M16 / IG 3/8" and Male M18 Neoperl® chrome housing dimensions for Tom Thumb (TT) aerator

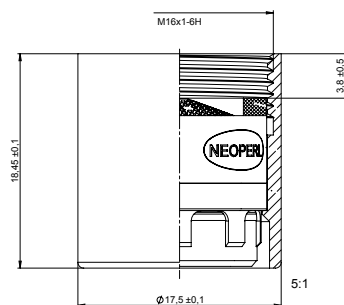

### Female M16 housing

Part no.: 44.xxxx.023 (xxxx depending on insert)

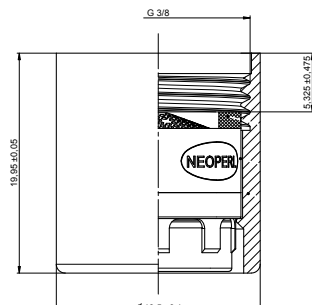

### IG 3/8" housing

Part no.: 44.xxxx.043 (xxxx depending on insert)

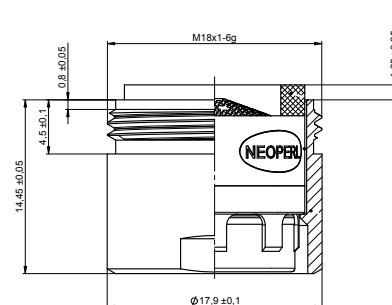

### Male M18 housing

Part no.: 44.xxxx.033 (xxxx depending on insert)

## Junior (JR) Size PCA® Model – Pressure Compensating Aerator

The pressure compensating flow regulator produces – by means of the o-ring – an almost constant flow rate regardless of pressure fluctuations

**JR Perlator® Honeycomb** for water pressure 1 bar – 6 bar

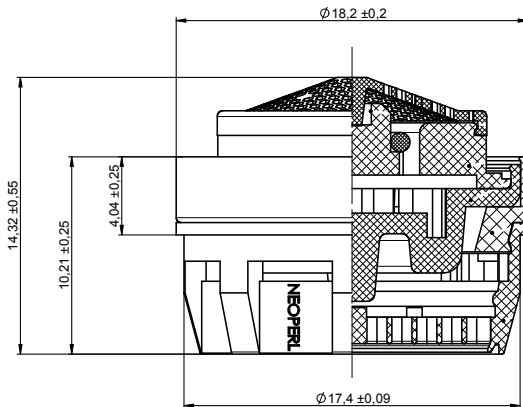

Junior (JR) Size PCA® Models			Order Codes		
Flow Rate Litres/min (± 10%)	Flow Rate US gallons/min	Colour Code	Junior (JR) Insert only	Fem 3/4"-27 UNS-2B Housing & Washer	Male 13/16"-27 UNS-2A Housing & Washer
	0.5 gpm max.	Lime	RP/42.2059.000	RP/42.2059.033	RP/42.2059.023
	1.0 gpm max.	Blue	RP/42.3058.000	RP/42.3058.033	RP/42.3058.023
	1.2 gpm max.	Pink	RP/42.3060.000	RP/42.3060.033	RP/42.3060.023
	1.5 gpm max.	Green	RP/42.3056.000	RP/42.3056.033	RP/42.3056.023
	1.75 gpm max.	Light Blue	RP/42.3061.000	RP/42.3061.033	RP/42.3061.023
	2.0 gpm max.	Lilac	RP/42.3057.000	RP/42.3057.033	RP/42.3057.023
	2.2 gpm max.	Yellow	RP/42.3053.000	RP/42.3053.033	RP/42.3053.023

**Fem. 3/4"-27 UNS-2B and Male 13/16"-27 UNS-2A Neoperl® chrome housing dims for junior (JR) aerator**

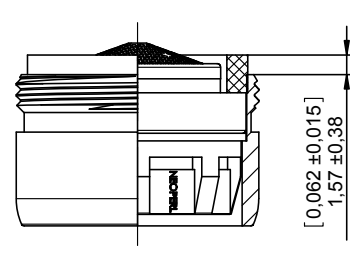
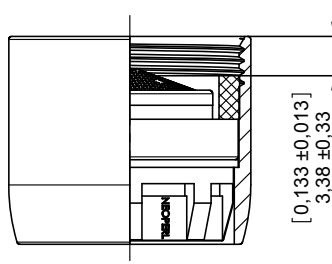

**ROBERT PEARSON & COMPANY LTD**

Post Office House, Post Office Lane  
Stockton, Warminster  
Wiltshire BA12 0SE

Telephone: (01985) 850954

Facsimile: (01985) 850112

E-Mail: [sales@robertpearson.co.uk](mailto:sales@robertpearson.co.uk)

Website: [www.robertpearson.co.uk](http://www.robertpearson.co.uk)