

# Water Saving Programmable Sensor Taps

**Optional Automatic "Purge" Facility available for taps not used for long periods**

Use up to 70% less water than conventional taps. Can help achieve BREEAM points

Hygienic "touch-free" sensor operation • Mains or battery powered kits available

Water & energy conservation • Ideal for disabled facilities • Infection control

To operate simply put your hands in front of the sensor. Remove your hands and the tap will automatically turn itself off again after a few seconds.

## Panel Mounted Brushed Stainless Steel Sensor Tap Kits



**Panel Mounted Sensor Tap Kit**  
(150mm spout projection)

Mains Powered: **SSTW-M/150mm**

Battery Powered: **SSTW-B/150mm**

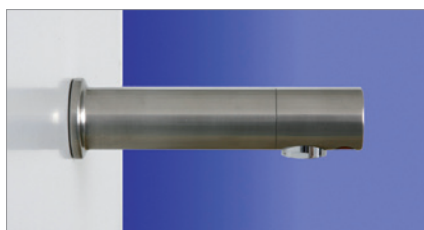
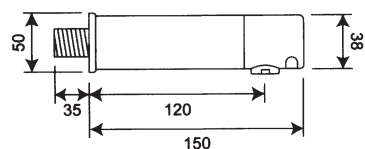

**Panel Mounted Sensor Tap**  
(200mm spout projection)

Mains Powered: **SSTW-M/200mm**

Battery Powered: **SSTW-B/200mm**

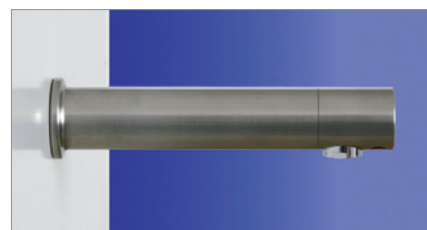
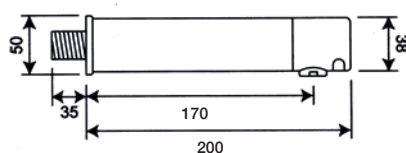

**Panel Mounted Sensor Tap**  
(250mm spout projection)

Mains Powered: **SSTW-M/250mm**

Battery Powered: **SSTW-B/250mm**

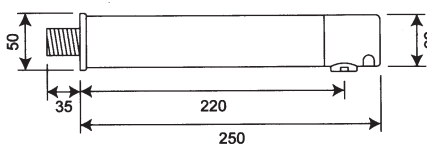

**Fitting:** Sensor is at spout end. Tap should be fitted on wall minimum 300mm above bottom of basin (450mm minimum if basin is metallic). **NB:** Please make sure there are no lights shining (or being reflected) directly into the sensor as this can make the tap false trigger.

### TECHNICAL DATA (all spout projections)

Standard Finish ..... **Brushed Stainless Steel**

Optional Finish ..... **Polished Steel**

Standard flow rate ..... **5 Lpm**

Optional flow rates (please specify) ..... **1.9, 3.8, 6 or 8 Lpm**

*Optional unrestricted laminar insert for low pressure water applications on request*

# Basin/Deck Mounted Sensor Tap Kits

## Basin/Deck Mounted Brushed Stainless Steel Sensor Tap Kits



### Shortneck

Mains Powered: **SSSN-M**  
Battery Powered: **SSSN-B**

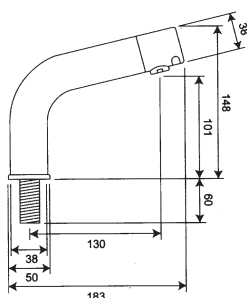

Fixing 3/4" BSP (28mm Ø clearance drill hole)



### 45° Spout Projection

Mains Powered: **SS45-M**  
Battery Powered: **SS45-B**

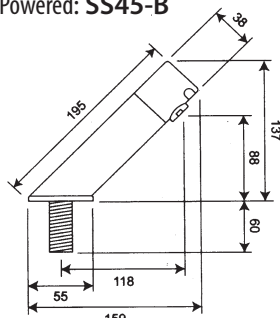

Fixing 3/4" BSP (28mm Ø clearance drill hole)

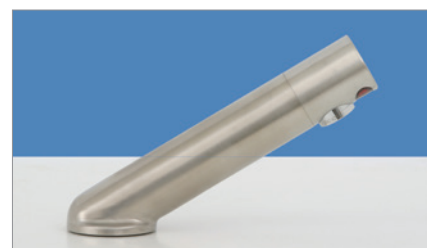

### 32° Spout Projection

Mains Powered: **SS32-M**  
Battery Powered: **SS32-B**

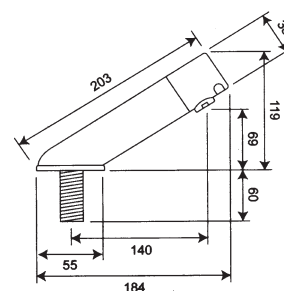

Fixing 3/4" BSP (28mm Ø clearance drill hole)

#### TECHNICAL DATA (all spout projections)

Standard Finish ..... **Brushed Steel**  
Optional Finish ..... **Polished Steel**  
Standard flow rate ..... **5 Lpm**

Optional flow rates ..... **1.9, 3.8, 6, 8 Lpm**  
*Optional unrestricted insert for low water pressure applications on request*

## Basin/Deck Mounted Chrome Sensor Tap Kits



### Shortneck

Mains Powered: **CPTSN-M**  
Battery Powered: **CPTSN-B**

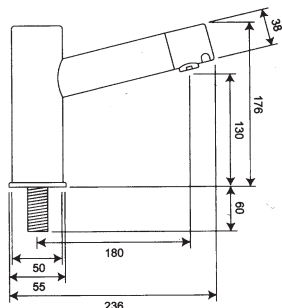

Fixing 3/4" BSP (28mm Ø clearance drill hole)



### Sensor Tap

Mains Powered: **CMT-M**  
Battery Powered: **CMT-B**

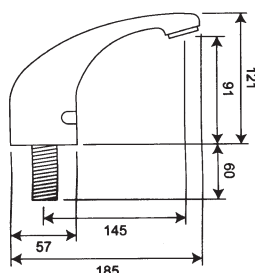

Fixing 3/4" BSP (28mm Ø clearance drill hole)



### Swan Neck Sensor Tap

Mains Powered: **CSN-M**  
Battery Powered: **CSN-B**

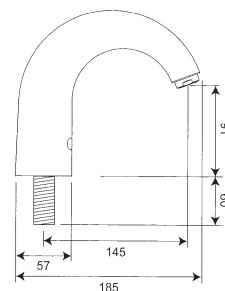

Fixing 3/4" BSP (28mm Ø clearance drill hole)

#### TECHNICAL DATA (all spout projections)

Finish ..... **Chrome**  
Standard flow rate ..... **5 Lpm**  
Optional flow rates ..... **1.9, 3.8, 6, 8 Lpm**

*Optional unrestricted insert for low water pressure applications on request*

# Highneck Deck Mounted Sensor Tap Kits

## Brushed Stainless Steel Highneck Sensor Tap Kits



### Brushed Stainless Steel Highneck (for vessel basins)

Mains Powered: **SSHN-M**

Battery Powered: **SSHN-B**

#### TECHNICAL DATA

Standard Finish ..... **Brushed Steel**

Optional Finish ..... **Polished Steel**

Standard flow rate ..... **5 Lpm**

Optional flow rates ..... **1.9, 3.8, 6, 8 Lpm**

*Optional unrestricted insert for very low water applications on request*

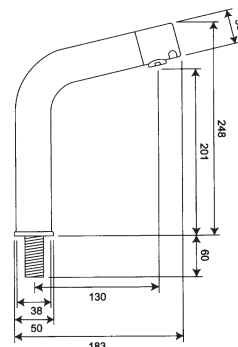

Fixing 3/4" BSP (28mm Ø clearance drill hole)

## Chrome Highneck Sensor Tap Kits



### Chrome Highneck Sensor Tap (for vessel basins)

Mains Powered: **CPTHN-M**

Battery Powered: **CPTHN-B**

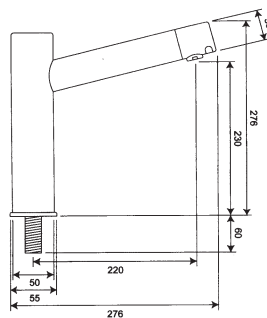

Fixing 3/4" BSP (28mm Ø clearance drill hole)

#### TECHNICAL DATA

Finish ..... **Chrome**

Standard flow rate ..... **5 Lpm**

Optional flow rates ..... **1.9, 3.8, 6, 8 Lpm**

*Optional unrestricted insert for very low water applications on request*

## Hand Held Programmer



### Optional Hand Held Programmer to allow you to alter:

- water run-on time per operation
- sensitivity
- optional automatic purge facility (to help reduce dead-legs)
- optional 2 minute valve open chlorination facility
- lock-out
- download data such as how many times the tap has been activated (or purged) via USB

Please specify correct UK Water Reg 4 Solenoid Valves for your site conditions

### Kiwa (KUKreg4)

#### Standard high pressure (HP) 0.75 Bar – 10 Bar

##### ORDER CODE

15mm 6v G202 Valve

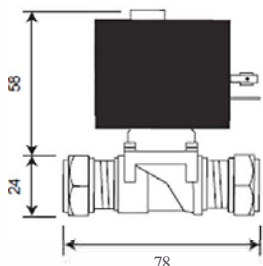

##### TECHNICAL DATA

Material ..... Brass  
O-ring/washers..... Nitrile  
Pressure rating ..... 0.75 Bar – 10 Bar  
Orifice ..... 12.7mm  
Connection ..... 15mm compression  
Voltage ..... 6vDC  
Operation type ..... Latching

### WRAS Approved

#### Optional low pressure (LP) 0 Bar – 1.5 Bar maximum

##### ORDER CODE

15mm 6v (4mm) Valve

##### TECHNICAL DATA

Material ..... Brass  
O-ring/washers..... Nitrile  
Pressure rating ..... 0 Bar – 1.5 Bar max.  
Orifice ..... 4mm  
Connection ..... 15mm compression  
Voltage ..... 6vDC  
Operation type ..... Latching

##### PRESSURE (Bar) FLOW RATE (Approx.)

0.1 Bar	2.20 l/min
0.2 Bar	3.20 l/min
0.3 Bar	3.90 l/min
0.4 Bar	4.50 l/min
0.5 Bar	5.00 l/min

### WRAS Approved

#### Optional very low pressure (VLP) 0 Bar – 0.45 Bar maximum

##### ORDER CODE

15mm 6v (6.7mm) Valve

##### TECHNICAL DATA

Material ..... Brass  
O-ring/washers..... Nitrile  
Pressure rating ..... 0 Bar – 0.5 Bar max.  
Orifice ..... 6.7mm  
Connection ..... 15mm compression  
Voltage ..... 6vDC  
Operation type ..... Latching

##### PRESSURE (Bar) FLOW RATE (Approx.)

0.1 Bar	4.30 l/min
0.2 Bar	6.10 l/min
0.3 Bar	7.50 l/min
0.4 Bar	8.70 l/min

**Water pressure:** The standard solenoid valve is rated for water pressures of 0.75 Bar – 10 Bar, although we suggest a maximum pressure of 5 Bar. We also offer optional low pressure valves.

**Electrical requirements:** Each mains-powered kit requires a 3 amp protected fused spur. If specified at time of order we can arrange the kits so you can run up to 3 taps from a single 6v Power Supply Unit. You will need an additional 'Y' connector for our 2 tap kits, and 2 additional 'Y' Connectors and an extension 'D'-lead for our 3 tap kits.

**Tap Tails:** Taps come supplied with PEX lined WRAS approved flexi-hose pipes. Optional copper tails available on request on most models.

**NB:** Please make sure there are no lights shining (or being reflected) directly into the sensor as this can make the tap false trigger.



## ROBERT PEARSON & COMPANY LTD

Post Office House, Post Office Lane  
Stockton, Warminster  
Wiltshire BA12 0SE

Telephone: (01985) 850954

Facsimile: (01985) 850112

E-Mail: [sales@robertpearson.co.uk](mailto:sales@robertpearson.co.uk)

Website: [www.robertpearson.co.uk](http://www.robertpearson.co.uk)