

# Caché Model Flow Regulator and Laminar

**NO PLUMBING REQUIRED | WATER & ENERGY SAVING | EVEN WATER DISTRIBUTION**

Simply replace existing tap aerator or flow straightener. The CACHÉ® insert is screwed directly into the tap eliminating the need for a housing

## Neoperl Caché® Laminar | PCA® (Pressure Compensating) Model

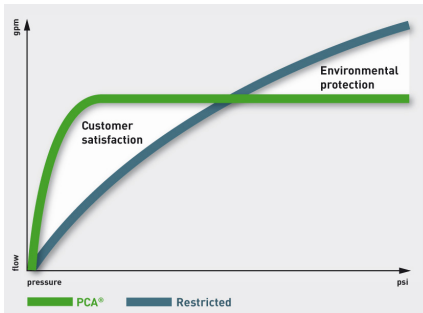

Water consumption: as much as necessary (customer satisfaction), but only as little as possible (environmental protection).

### PCA® versions provide a constant & maximum flow rate irrespective of pressure fluctuations

All Neoperl PCA® inserts are equipped with a flow regulator. The flow regulator is composed of a **colour-coded body** and a **dynamic o-ring**. The o-ring reacts to pressure change and alters its shape to adjust the amount of water flowing through the flexible gap.

### Operating water pressure 1 Bar to 6 Bar

Where flow rates are stated in gallons/min (**gpm max.**) this refers to a US gallon (3.8 litre/min approx.) and the flow rate will not exceed that stated providing the water pressure is correct. Where flow rates are stated in litres/min (**l/min**) this is subject to  $\pm 10\%$  deviation.

**May not be used for hot water application exceeding 60°C**

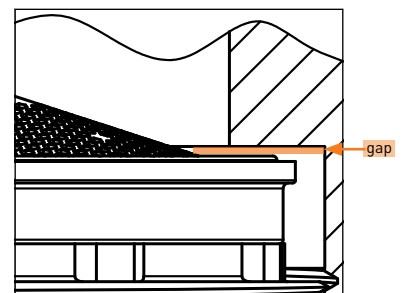
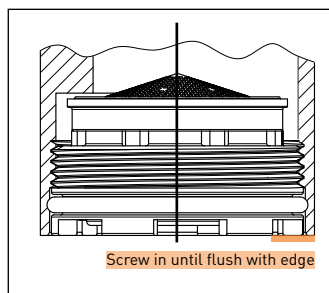
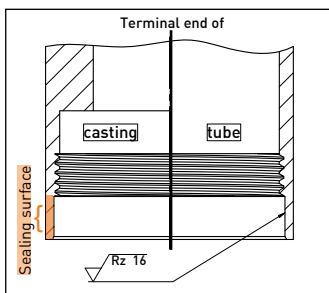

Due to radial sealing, make sure aerator is not screwed in to the limit but until CACHÉ® aerator is flush with edge. For pressure resistance reasons thread must be true to gauge.

## RP/LAMINAR/CACHÉ Perlator HC | Pressure Compensating Flow Regulator

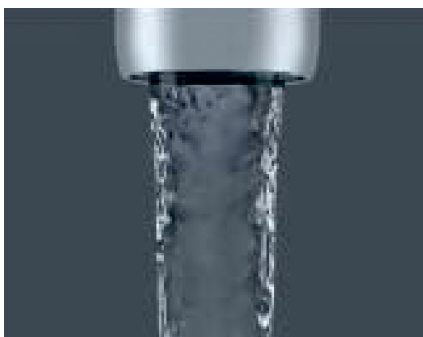

### LAMINAR STREAM (PURE)

Laminar stream straighteners produce a non-aerated water stream. Ideal for high-flow applications or health care facilities (no mix of water/air). NEOPERL® laminar spout-end devices deliver a crystal-clear and non-splashing stream.

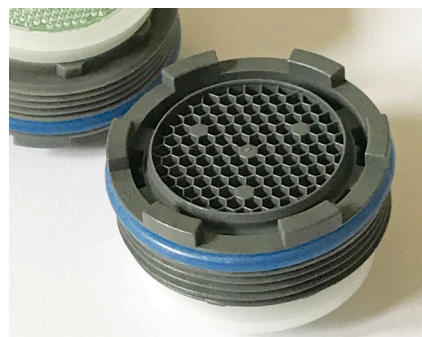

### PERLATOR® HC FEATURES

- extended life
- perfect stream quality even under difficult flow conditions
- very low noise level
- damage proof: unlike conventional wire mesh screens, the HONEYCOMB structure cannot be crushed
- integrated anti-clogging dome screen filters sediments and particles

### Available Sizes

- Standard (**STD**) – M24
- Junior (**JR**) – M21.5
- Tiny Junior (**TJ**) – M18.5
- Tom Thumb (**TT**) – M16.5

# PCA® Model – Pressure Compensating CACHÉ Insert

The pressure compensating flow regulator produces – by means of the o-ring – an almost constant flow rate regardless of pressure fluctuations

**Available Sizes—Perlator® HC Laminar Caché® for water pressure 1 bar**

Caché Inserts			Order Codes			
Flow Rate L/min (± 10%)	Flow Rate: US Gallons/min	Colour Code	M16.5 Tom Thumb (TT)	M18.5 Tiny Junior (TJ)	M21.5 Junior (JR)	M24 Standard (STD)
	0.35 gpm max.	Brown	RP/44.3368.010	–	–	–
	0.5 gpm max.	Lime	RP/44.3359.010	–	–	RP/40.2359.010
	1.0 gpm max.	Blue	RP/44.3358.010	RP/43.2358.010	RP/42.2358.010	RP/40.2358.010
	1.2 gpm max.	Pink	RP/44.3360.010	RP/43.2360.010	RP/42.2360.010	RP/40.2360.010
5.0 l/min		Orange	RP/44.3351.010	RP/43.2351.010	RP/42.2351.010	RP/40.2351.010
	1.5 gpm max.	Green	RP/44.3356.010	RP/43.2356.010	RP/42.2356.010	RP/40.2356.010
6.0 l/min		Black	–	–	–	RP/40.2352.010
	1.75 gpm max.	Light Blue	RP/44.3361.010	RP/43.2361.010	RP/42.2361.010	RP/40.2361.010
7.0 l/min		Light Green	RP/44.3355.010	RP/43.2355.010	RP/42.2355.010	RP/40.2355.010
	2.0 gpm max.	Lilac	RP/44.3357.010	RP/43.2357.010	RP/42.2357.010	RP/40.2357.010
	2.2 gpm max.	Yellow	RP/44.3353.010	RP/43.2353.010	RP/42.2353.010	RP/40.2353.010
8.0 l/min		White	RP/44.3354.010	RP/43.2354.010	RP/42.2354.010	RP/40.2354.010
	3.0 gpm max.	Brown	RP/44.3364.010	–	–	–

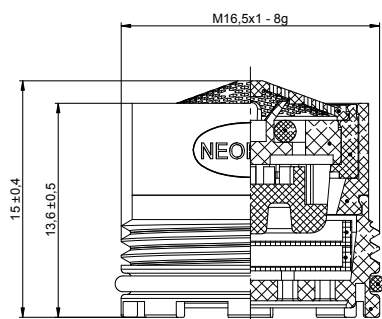

**M16.5 Tom Thumb (TT) Dimensions**

## Caché Service Key

Order Codes:

- RP/CACHE/KEY/TT
- RP/CACHE/KEY/TJ
- RP/CACHE/KEY/JR
- RP/CACHE/KEY/STD

Approximate size guide for caché service keys:  
Yellow (TT) = 16mm, Green (TJ) = 18mm  
Red (JR) = 21mm, Grey (STD) = 24mm

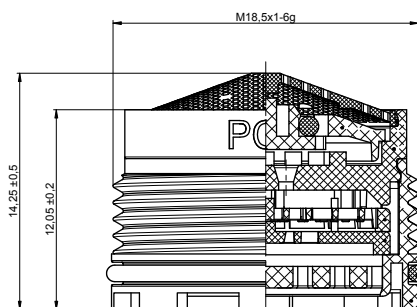

**M18.5 Tiny Junior (TJ) Dimensions**

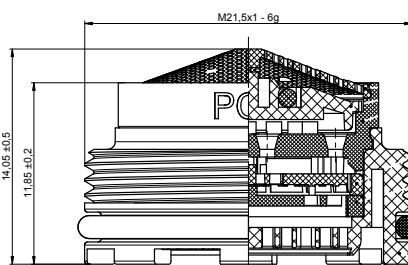

**M21.5 Junior (JR) Dimensions**

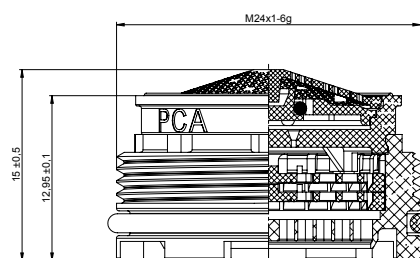

**M24 Standard (STD) Dimensions**

## PCA® Model – Pressure Compensating CACHÉ Coin Slot Insert

The pressure compensating flow regulator produces – by means of the o-ring – an almost constant flow rate regardless of pressure fluctuations

**Available Sizes—HC Laminar Caché® Coin Slot for water pressure 1 bar – 6 bar**

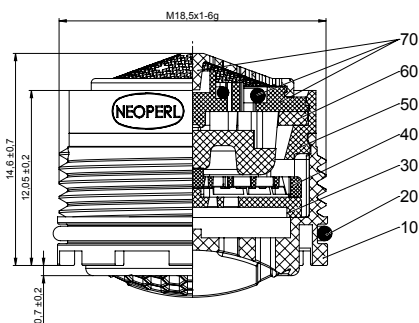

**M18.5 Tiny Junior (TJ) Dimensions**

Caché Inserts			Order Code
Flow Rate L/min (± 10%)	Flow Rate: US Gallons/min	Colour Code	M18.5 Tiny Junior (TJ)
	1.0 gpm max.	Blue	RP/43.3313.010
	1.2 gpm max.	Pink	RP/43.3314.010
	1.5 gpm max.	Green	RP/43.3315.010
	1.75 gpm max.	Light Blue	RP/43.3317.010

## PCA® Model – Pressure Compensating CACHÉ Insert

The pressure compensating flow regulator produces – by means of the o-ring – an almost constant flow rate regardless of pressure fluctuations

## RP/LAMINAR/CACHÉ Cascade SLC | Pressure Compensating Flow Regulator

**Available Sizes—Cascade SLC Laminar Caché® for water pressure 1 bar – 6 bar**

### SLC (SMART LIME CLEANING)

- soft elastomer layer: lime deposits can easily be rubbed off
- closed inner nozzle ring for flow class 0.35 gpm

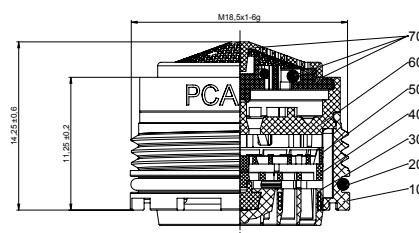

**M18.5 Tiny Junior (TJ) Dimensions**

Caché Inserts			Order Code
Flow Rate L/min (± 10%)	Flow Rate: US Gallons/min	Colour Code	M18.5 Tiny Junior (TJ)
	1.0 gpm max.	Blue	RP/43.0313.010
	1.2 gpm max.	Pink	RP/43.0314.010
	1.5 gpm max.	Green	RP/43.0315.010
	1.75 gpm max.	Light Blue	RP/43.0317.010
	2.1 gpm max.	Red	RP/43.0316.010



## ROBERT PEARSON & COMPANY LTD

Post Office House, Post Office Lane  
Stockton, Warminster  
Wiltshire BA12 0SE

Telephone: (01985) 850954

Facsimile: (01985) 850112

E-Mail: [sales@robertpearson.co.uk](mailto:sales@robertpearson.co.uk)

Website: [www.robertpearson.co.uk](http://www.robertpearson.co.uk)