

Anti-ligature Sensor (or Touchpad) Controls for HSBP-BASIN Backplate

These sensors or touchpads fit into the backplate

No Touch Sensor

To operate put hands within 2" or 50mm of the sensor

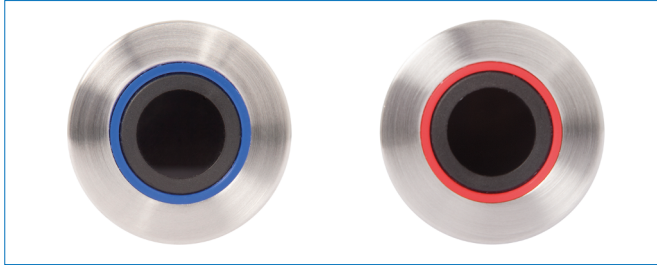

Touchpad Switches

Require a small push to make the contact

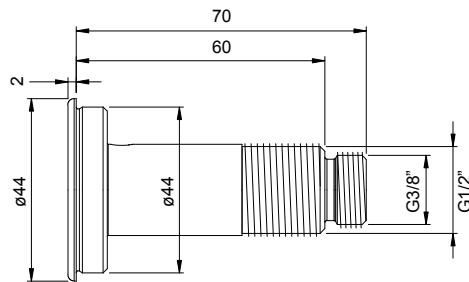
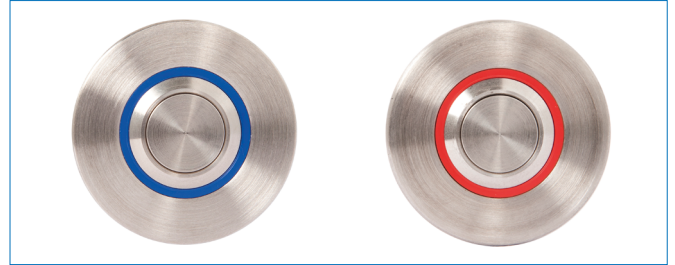

Please confirm total wall thickness as you may require optional extension threads.
Pre-wired with 3m cable as standard. Longer cable lengths available. If required, please contact us.

Mains Powered Kits

HSBP-BASIN Backplate Controls—Mains powered

TPTS-M/HP/Basin Backplate 2 × Sensor kit

TPTS-M/HP/Basin Backplate 2 × Touchpad kit

Each kit c/w: 1 × control box with integral 12v PSU, 2 × 15mm HP 12v solenoid valves, 2 × pre-wired sensors or touchpads (1 red, 1 blue).

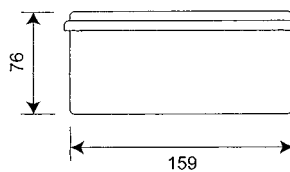
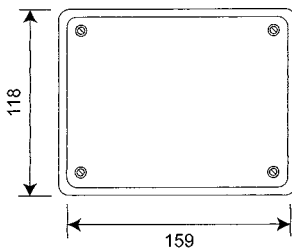

Standard tap control box with adjustable valve open time from 6 seconds to 20 seconds. *Call to discuss* for options if you require a longer valve open time.

Standard High Pressure (HP) 12v solenoid valves 0.5 bar – 6 bar



Optional low pressure WRAS valves available on request rated 0 bar - 0.5 bar max.

Please specify correct valves for your site conditions

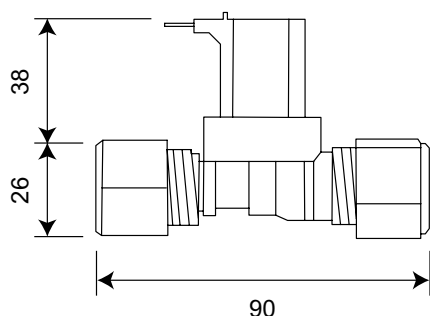

For mains powered kits

Standard high pressure (HP)

12v nylon pre-wired 15mm solenoid valve for mains powered kits.

Working Temperature Range 0°C to 60°C
Electrical connection: Spade connectors / 2-core Ø0.5mm copper cable

TECHNICAL DATA

Gross weight	0.215 kg
Material	Nylon
Seal Material	NBR (Nitrile)
Voltage	12vDC
Power	3W
Connection	15mm Compression
Pressure rating	0.5 Bar – 6 Bar
Operation type	Normally closed
Cable length	3m

Battery Powered Kits

HSBP-BASIN Backplate Controls—Battery powered

TPTS-B/HP/Basin Backplate 2 × Sensor kit

TPTS-B/HP/Basin Backplate 2 × Touchpad kit

Each kit c/w: 1 × control box & battery pack, 2 × 15mm G202 HP 6v solenoid valves, 2 × pre-wired sensors or touchpads (1 red, 1 blue).

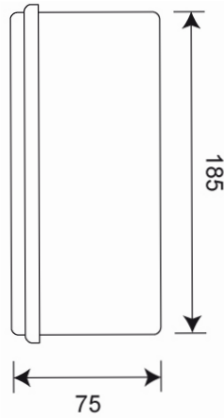
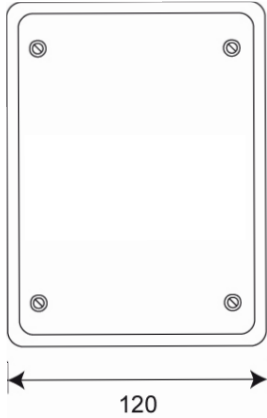

Standard tap control box with adjustable valve open time from 6 seconds to 20 seconds.

Standard High Pressure (HP) 6v solenoid valves 0.75 bar – 10 bar



Optional Low Pressure (LP) version with solenoid valves rated for 0 bar – 1.5 bar max.

Optional Very Low Pressure (VLP) version with solenoid valves rated for 0 bar – 0.5 bar max.

Please specify correct valves for your site conditions

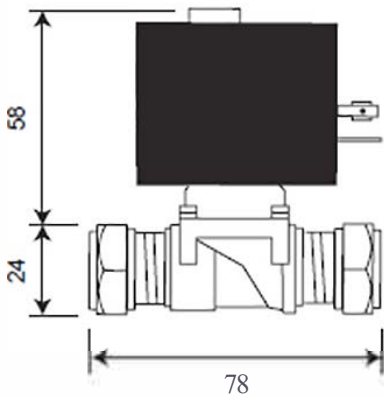

For battery powered kits

Standard high pressure (HP)

6v non-wired G202 solenoid valve for battery powered kits. You will need to provide length of 2 core cable from valve to control box.

TECHNICAL DATA

Material ABS/Brass

O-ring/washers..... Nitrile material

Fitting 15mm Compression

Pressure rating 0.75 Bar – 10 Bar



ROBERT PEARSON & COMPANY LTD

Post Office House, Post Office Lane
Stockton, Warminster
Wiltshire BA12 0SE

Telephone: (01985) 850954

Facsimile: (01985) 850112

E-Mail: sales@robertpearson.co.uk

Website: www.robertpearson.co.uk