

Anti-ligature Sensor (or Touchpad) Controls for HSBP-BATH

These sensors or touchpads fit into the backplate

No Touch Sensor

To operate put hands within 2" or 50mm of the sensor

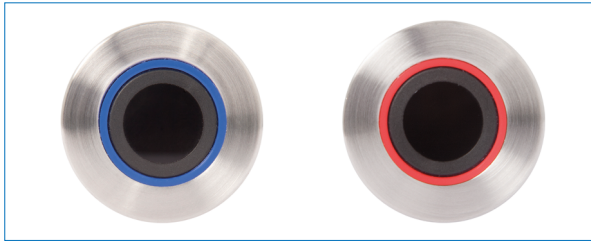

Touchpad Switches

Require a small push to make the contact

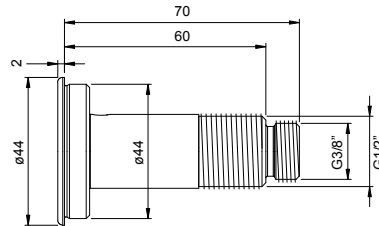
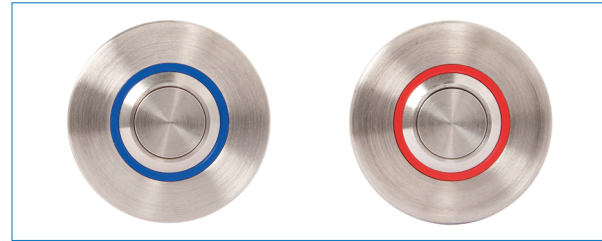

Please confirm total wall thickness as you may require optional extension threads.

Pre-wired with 3m cable as standard. Longer cable lengths available. If required, please contact us.

Mains Powered Kits

HSBP-BATH Backplate Controls for 15mm pipework

TPTS-M/HP Bath Backplate 2 × Sensor kit

TPTS-M/HP Bath Backplate 2 × Touchpad kit

Each kit c/w: 1 × control box with integral 12v PSU, 2 × 15mm HP 12v solenoid valves, 2 × pre-wired sensors or touchpads (1 red, 1 blue).

HSBP-BATH Backplate Controls for 22mm pipework

TPTS-M/HP^{3/4}" Bath Backplate 2 × Sensor kit

TPTS-M/HP^{3/4}" Bath Backplate 2 × Touchpad kit

Each kit c/w: 1 × control box with integral 12v PSU, 2 × ^{3/4}" BSP HP 12v solenoid valves, 2 × pre-wired sensors or touchpads (1 red, 1 blue).

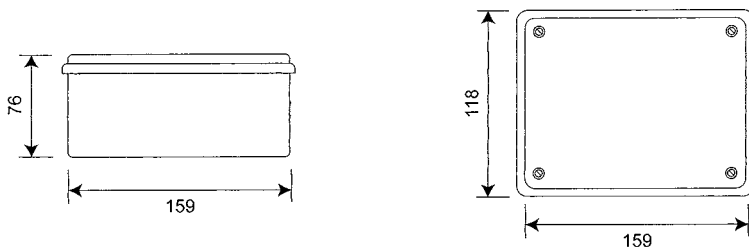

Standard bath control box with adjustable valve open time from 1 minute to 10 minutes.



Standard 15mm High Pressure (HP) 12v solenoid valves 0.5 bar – 6 bar

For mains powered kits

Standard high pressure (HP)

12v nylon pre-wired 15mm solenoid valve for mains powered kits.

Working Temperature Range 0°C to 60°C
Electrical connection: Spade connectors / 2-core Ø0.5mm copper cable

TECHNICAL DATA

Gross weight	0.215 kg
Material	Nylon
Seal Material	NBR (Nitrile)
Voltage	12vDC
Power	3W
Connection	15mm Compression
Pressure rating	0.5 Bar – 6 Bar
Operation type	Normally closed
Cable length	3m

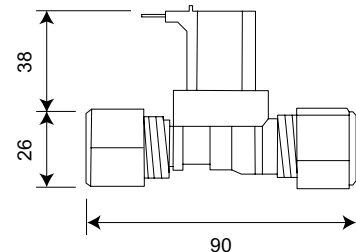

Optional ^{3/4}" BSP High Pressure (HP) 12v solenoid valves 0.5 bar – 8 bar

For mains powered kits

Optional high pressure (HP^{3/4}"

12v (19mm orifice) solenoid valve for mains powered kits.

You will need to provide length of 2 core cable from valve to control box.

TECHNICAL DATA

Material	ABS/Brass
O-ring/washers	Nitrile
Pressure rating	0.5 Bar – 8 Bar max.
Orifice	19mm
Connection	^{3/4} " BSP
Voltage	12vDC
Operation type	Normally closed

LOW PRESSURE OPTION (LP)

WRAS approved low pressure (LP) ^{3/4}" BSP valve for water pressure 0 bar – 1 bar available on request

Battery Powered Kits

HSBP-BATH Backplate Controls for 15mm pipework

TPTS-B/HP Bath Backplate 2 × Sensor kit

TPTS-B/HP Bath Backplate 2 × Touchpad kit

Each kit c/w: 1 × control box & battery pack,
2 × 15mm G202 HP 6v solenoid valves, 2 × pre-wired
sensors or touchpads

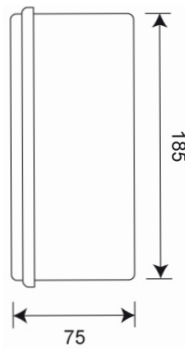
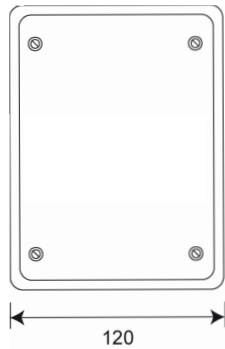

HSBP-BATH Backplate Controls for 22mm pipework

TPTS-B/¾" Bath Backplate 2 × Sensor kit

TPTS-B/¾" Bath Backplate 2 × Touchpad kit

Each kit c/w: 1 × control box & battery pack,
2 × ¾" BSP 6v solenoid valves, 2 × pre-wired sensors or
touchpads (1red, 1 blue).

Standard bath control box with
adjustable valve open time from
1 minute to 10 minutes.



Standard 15mm High Pressure (HP) 6v solenoid valves 0.75 bar – 10 bar

For battery powered kits Standard high pressure (HP)

6v non-wired G202 solenoid valve for
battery powered kits. You will need to
provide length of 2 core cable from
valve to control box.

TECHNICAL DATA

Material ABS/Brass
O-ring/washers..... Nitrile
material
Fitting 15mm Compression
Pressure rating 0.75 Bar – 10 Bar

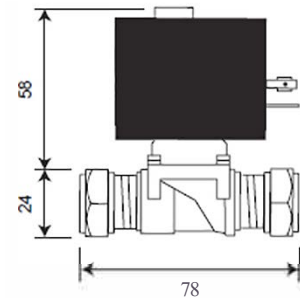

Optional ¾" BSP 6v solenoid valves 0 bar – 6 bar

For battery powered kits

Optional ¾" valve (for 22mm pipe) 0 Bar – 6 Bar

6v (19mm orifice) solenoid valve for
battery powered kits.

You will need to provide length of 2 core
cable from valve to control box

TECHNICAL DATA

Material ABS/Brass
O-ring/washers..... Nitrile
Pressure rating 0 Bar – 6 Bar
Orifice 19mm
Connection ¾" BSP
Voltage 6vDC
Operation type Latching



ROBERT PEARSON & COMPANY LTD

Post Office House, Post Office Lane
Stockton, Warminster
Wiltshire BA12 0SE

Telephone: (01985) 850954

Facsimile: (01985) 850112

E-Mail: sales@robertpearson.co.uk

Website: www.robertpearson.co.uk