

# Anti-ligature Sensor (or Touchpad) Controls for HSWHB-INT-MONO Integrated Basin & Backplate

These sensors or touchpads fit into the backplate

## No Touch Sensor

To operate put hands within 2" or 50mm of the sensor

## Touchpad Switches

Require a small push to make the contact

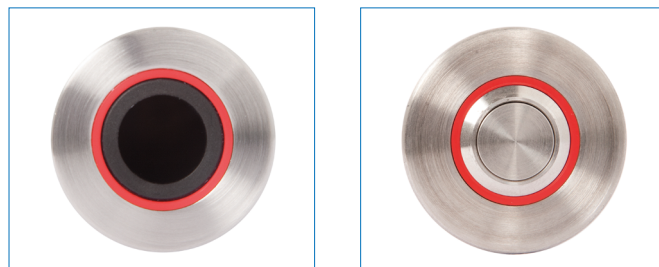
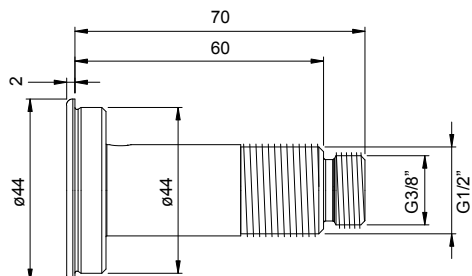

Please confirm total wall thickness as you may require optional extension threads.  
Pre-wired with 3m cable as standard. Longer cable lengths available. If required, please contact us.

## Mains Powered Kits

### HSWHB-INT-MONO Backplate Controls—Mains powered

TPTS-M/HP/Mono Basin Backplate Sensor kit

TPTS-M/HP/Mono Basin Backplate Touchpad kit

Each kit c/w: 1 x control box with integral 12v PSU, 1 x 15mm HP 12v solenoid valve, 1 x red pre-wired sensor or 1 x red touchpad.

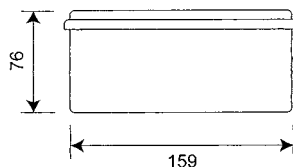
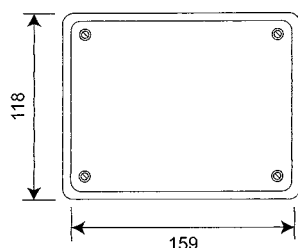

Standard tap control box with adjustable valve open time from 6 seconds to 20 seconds. *Call to discuss* for options if you require a longer valve open time.

## Standard High Pressure (HP) 12v solenoid valves 0.5 bar – 6 bar



Optional low pressure WRAS valves available on request rated 0 bar - 0.5 bar max.

Please specify correct valves for your site conditions

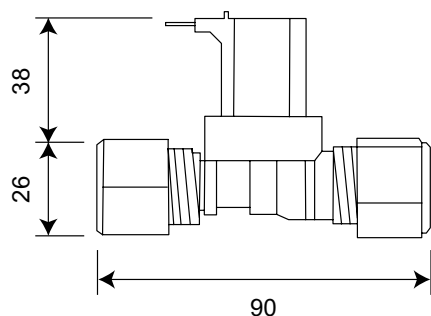

### For mains powered kits Standard high pressure (HP)

12v nylon pre-wired 15mm solenoid valve for mains powered kits.

Working Temperature Range 0°C to 60°C  
Electrical connection: Spade connectors / 2-core Ø0.5mm copper cable

### TECHNICAL DATA

Gross weight ..... 0.215 kg  
Material ..... Nylon  
Seal Material ..... NBR (Nitrile)  
Voltage ..... 12vDC  
Power ..... 3W  
Connection ..... 15mm Compression  
Pressure rating ..... 0.5 Bar – 6 Bar  
Operation type ..... Normally closed  
Cable length ..... 3m

**Battery Powered Kits**

**HSWHB-INT-MONO Backplate Controls—Battery powered**

TPTS-B/HP/Mono Basin Backplate Sensor kit

TPTS-B/HP/Mono Basin Backplate Touchpad kit

**Each kit c/w:** 1 × control box & battery pack, 1 × 15mm G202 HP 6v solenoid valve, 1 × red pre-wired sensor or 1 × red pre-wired touchpad.

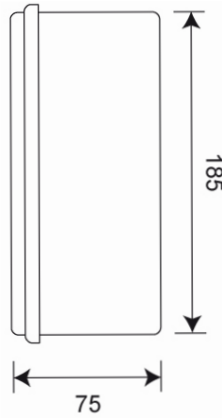
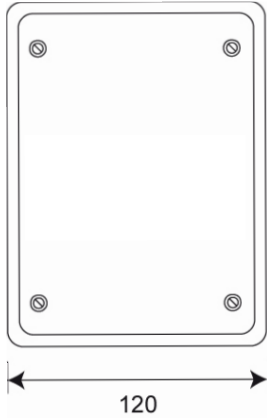

Standard tap control box with adjustable valve open time from 6 seconds to 20 seconds.

**Standard High Pressure (HP) 6v solenoid valves 0.75 bar – 10 bar**



**Optional Low Pressure (LP) version with solenoid valves rated for 0 bar – 1.5 bar max.**

**Optional Very Low Pressure (VLP) version with solenoid valves rated for 0 bar – 0.5 bar max.**

Please specify correct valves for your site conditions

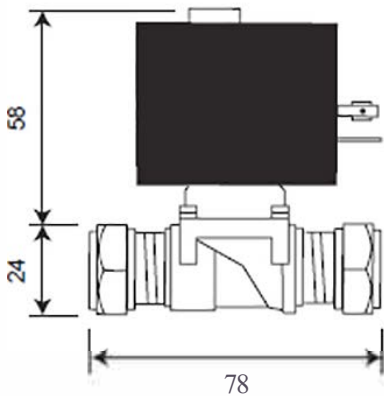

**For battery powered kits**  
**Standard high pressure (HP)**  
 6v non-wired G202 solenoid valve for battery powered kits. You will need to provide length of 2 core cable from valve to control box.

**TECHNICAL DATA**  
 Material ..... ABS/Brass  
 O-ring/washers..... Nitrile material  
 Fitting ..... 15mm Compression  
 Pressure rating ..... 0.75 Bar – 10 Bar



**ROBERT PEARSON & COMPANY LTD**

Post Office House, Post Office Lane  
 Stockton, Warminster  
 Wiltshire BA12 0SE

Telephone: (01985) 850954  
 Facsimile: (01985) 850112  
 E-Mail: sales@robertpearson.co.uk  
 Website: www.robertpearson.co.uk