

Timer Controlled Actuated Ball Valve | 0 – 10 Bar

Actuator available in 9–24vAC/DC option or 110–240vAC option

Programmable start OPEN or start CLOSED. OPEN/CLOSE time from 0 to 99 hr 59 min 59 sec

Allows you to:

- Purge water systems to help reduce dead legs
- Drain (or fill) water systems
- Remotely actuate irrigation systems

9–24vAC/DC Option

Suitable for water pressure: 0–10 Bar

Moving: 5 Watts

Holding: 0.22 Watts

Order Codes:

1/2" RP/T-ABVM/9-24V

3/4" RP/T-ABVM/9-24V

1" RP/T-ABVM/9-24V

110–240vAC Option

Suitable for water pressure: 0–10 Bar

Moving: 5 Watts

Holding: 0.6 Watts

Order Codes:

1/2" RP/T-ABVM/110-240V

3/4" RP/T-ABVM/110-240V

1" RP/T-ABVM/110-240V

Technical Specification

Media: air – water – gases – liquid

Pressure range: 0 Bar – 10 Bar maximum

Media temperature: –15°C to +100°C

Ambient temperature: –15°C to +50°C

Media viscosity: 500 Centistokes max

Duty cycle: 70,000

Operating time: 7 Sec approx.

Valve Body: 304 stainless steel

Seals: Stem 2 × FKM

Ball – WRAS PTFE

Actuator: ABS Engineering Plastic; Gears - Metal

IP67 Enclosure; Torque – 2 Nm; Pre-wired – 0.5 metre;

Visual position indication; Digital readout Time OPEN

Time CLOSED; Programmable Start OPEN or Start

CLOSED



Overall Dimensions

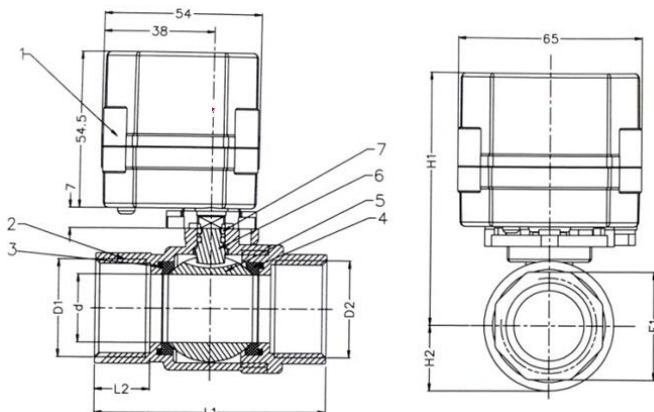

Port D1/D2	d	L1	L2	E1	H1	H2	Kg
1/2	15	63	14	25	83	17	0.4
3/4	20	72	17	31	87	20	0.5
1	25	81	18	38	95	24	0.6

Reference	Description	Material
1	Actuator	ABS
2	Body Cover	SS304
3	O Ring	FKM
4	Sealing	PTFE
5	Ball	SS304
6	Stem	SS304
7	O Ring	FKM

Setting

Remembers time settings if there is a power failure

<p style="text-align: center;">Set Valve Open Time: Requires electrical power to Valve</p> <p>Press and hold SET button 1 for 5 seconds displays t On valve open time</p> <p style="padding-left: 40px;">Press button 2 change 10 hour increment with button 3 Press button 2 change 1 hour increment with button 3 Press button 2 change 10 minute increment with button 3 Press button 2 change 1 minute increment with button 3 Press button 2 new screen change 10 second increment with button 3 Press button 2 change 1 second increment with button 3 To set close button press set button 1, follow below from*</p>	
<p style="text-align: center;">Set Valve Closed Time: Requires electrical power to Valve</p> <p>Press SET button 1 for 5 seconds displays t OFF valve closed time</p> <p style="padding-left: 40px;">*Press button 2 change 10 hour increment with button 3 Press button 2 change 1 hour increment with button 3 Press button 2 change 10 minute increment with button 3 Press button 2 change 1 minute increment with button 3 Press button 2 new screen change 10 second increment with button 3 Press button 2 change 1 second increment with button 3 To set open press button 1 set button until t On displayed</p>	<p style="text-align: center;">Change Valve Start Position: Valve Closed or Valve Open Requires electrical power to Valve Press SET button1 for 5 seconds</p> <p style="padding-left: 40px;">Press set button through menu t On, t OFF, Pons is displayed Press button 3 Change Start On (Valve Open) OR Start OFF (Valve Closed)</p> <p>Prot = Stall current setting milliAmps, when current exceeds set value motor stops and display shows Err code.</p>



ROBERT PEARSON & COMPANY LTD

Post Office House, Post Office Lane
 Stockton, Warminster
 Wiltshire BA12 0SE

Telephone: (01985) 850954
 Facsimile: (01985) 850112

E-Mail: sales@robertpearson.co.uk
 Website: www.robertpearson.co.uk